



VERUS SPEAKERS

OWNER'S MANUAL

Congratulations!

You're moments away from experiencing your new Verus III™ speakers. We're honored that you chose Aperion Audio to bring your music and movies to life!

Feel free to contact us if we can answer any questions or provide you with setup advice. Above all, enjoy!

-The Aperion Audio Team

Important Notes

- Please read these operating instructions carefully and keep them for reference.
- Aperion Audio cannot be held liable for any damage resulting from non-compliance with the following instructions.
- Choose a level, dry and clean place for your speakers, away from windows with direct sunlight, heat sources, vibrations, high humidity and extreme cold.
- Never open the housing. Contact our free of charge support in the event of problems or defects.
- Do not use force on the operating elements, connections or cables.
- Do not place your speaker close to heat sources or open flames (e.g. candles).
- Do not place any objects on the speaker housing or bass reflex opening. Oscillations and vibrations can damage them.
- Do not insert any objects or body parts into the speakers openings. Live components inside the housing could get touched and damaged. Turn down the volume immediately if sound distortions, such as unnatural knocking, beating or high-frequency clicking can be heard.
- Do not use any chemical solutions to clean the equipment. Use a clean, dry cloth.
- If exposed to severe temperature fluctuations, condensation (water drops) can form inside the speaker. In this case, wait for at least 2 hours until the moisture has evaporated before putting the equipment into operation.
- The power plug must always be accessible so that it can be removed in an emergency!
- The correct setup and connection of the speaker are the responsibility of the user. Aperion Audio will not accept any responsibility for damage or injuries caused by incorrect setup or faulty connection.

Connecting the Speaker

1. Connect a two-pole (+/-) loudspeaker cable to the binding posts, located at rear of the cabinet. The high quality, gold plated binding posts can accommodate different connection systems:

- Banana plugs: The pins can be put directly into the binding post without any tightening necessary.
- Cable spades: Loosen the binding posts, insert the spade into the opening, and secure the spade by tightening the posts.
- Bare wires: Loosen the binding posts and place the cable into the binding posts. Tighten the posts.

2. Connect the other cable ends to the loudspeaker outputs of your switched off power amp.

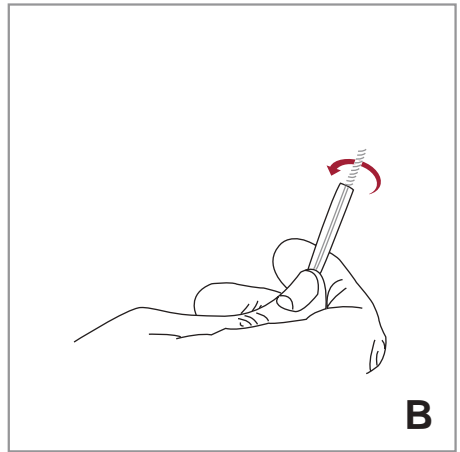
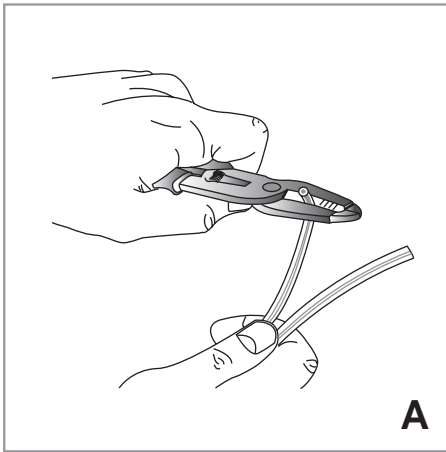

Connecting the Speaker

The loudspeaker cable can have an impact on sound quality. In general, quality cable products will yield a quality result. Make sure to keep the cable length as short as possible. We recommend the use of at least 14 AWG diameter for distances < 15m. Please make sure that all connectors are clean and not oxidized.

Connecting surround speakers

When connecting a two-channel stereo system, only the right and left channels are connected to the amplifier. In a surround set-up, center, side or rear loudspeakers as well as a subwoofer are typically connected to provide for a multi-channel listening experience. Please refer to the amplifier's owner manual

for particular connection instructions.

Placement

Following explanations refer to the figure below. The distance between each loudspeaker (A) and your listening position (B) should be about the same. Try to achieve an isosceles triangle.

The distance between the loudspeakers should be the same or slightly less than the distance between each loudspeaker and your listening position (A, B).

The closer the listening position is in relation to the loudspeakers, the closer the speakers can be positioned to each other.

As a starting point, it is recommended that the speakers be about 2 meters apart from each other for the best results (A).

If the speakers are positioned too close to each other, the stereo image will not seem realistic; if that distance is too wide, the image may leave an acoustic hole in the middle.

Paying attention to the image during listening tests will help dictate optimum placement during experimentation and set-up.

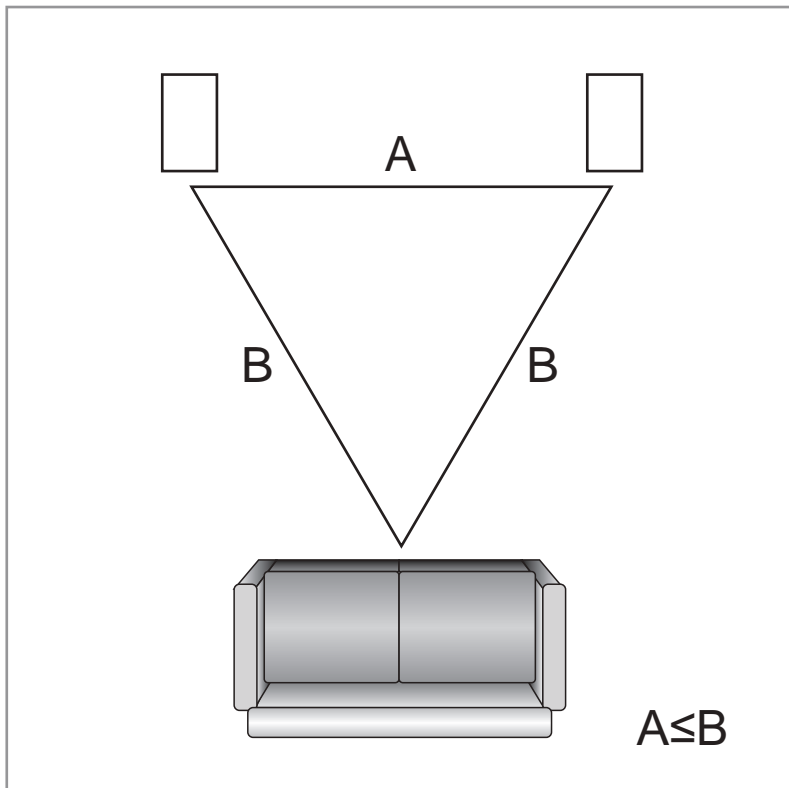

Distance to back and side walls

If a loudspeaker is placed near a wall, ceiling or floor, the lower frequencies will be amplified by the room.

Sometimes this is desirable, sometimes it is not (this may lead to indistinct bass reproduction).

The bass amplification becomes more obvious if the speaker is placed near a corner. Thus, for a clear sound the speaker should be placed at least 20 cm (about 8 inches) away from the wall. However, there are exceptions room this rule. For some types of walls/rooms it may be an advantage placing the loudspeaker closer to the wall.

Room and furniture influence

The sound quality of any loudspeaker is influenced by the furniture, wall materials and other objects in the listening room. For example, large rooms without much furniture and clean, hard wall surfaces can give a bright and diffuse sound with diverse echoing frequencies. A room with thick carpet, curtains and soft furniture surfaces will give a warmer and darker sound.

Multi-Channel Setup

Our loudspeakers are designed to offer the most advanced performance in both stereo and multi-channel applications. When connecting a loudspeaker to a multi-channel setup, the same general guidelines as mentioned above will apply.

Note

When setting up a home theater system, the loudspeakers should create a realistic sound stage with similar sound characteristics on each channel. It is therefore important that all speakers should match the same quality level. This is especially important with regards to the center channel loudspeaker, as this is the most critical aspect of any home theater sound stage.

Center speaker

The center speaker is responsible for the information directed from the middle of the screen and should be positioned between the right and left main loudspeakers. In a home theater/surround setup, the center supports the images and should be placed close to the screen.

Rear speakers

The rear speakers are responsible for the surround effects behind the listening position. When using the bookshelf models as rear speakers, the speakers can be placed into a shelf, mounted at the rear wall or placed on a stand. This allows you a wide variety of placements, even if your listening room and furniture orientation prevent an ideal setup. The picture below shows the optimal placement for surround speakers in a 5.1 and 7.1 speaker system.

5.1

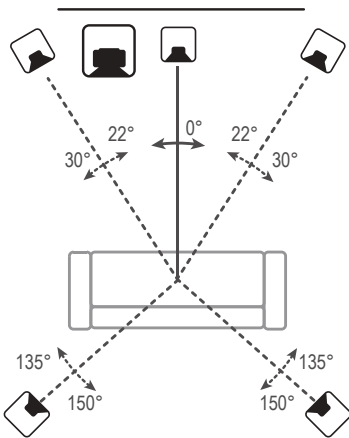

7.1

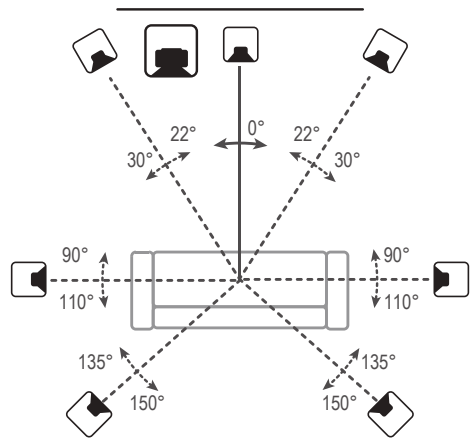

Subwoofer

Most often a subwoofer will be utilized for the LFE-signal, especially in larger listening rooms. The position of the subwoofer will be dependent upon the size of the room and its acoustics. Please refer to the Subwoofer manual.

Break-in Period

The moving parts of a newly manufactured Aperion loudspeaker have been acoustically checked after production, but nevertheless are not as flexible as they need to be for optimum results to be realized. The higher the quality of any driver system, the more demanding the loudspeaker will be regarding time for running-in the system. A newly unpacked Aperion loudspeaker therefore requires 20 - 40 hours of running/ playing to reach its optimum performance capability.

Cleaning the loudspeakers

Switch off all components of your system when cleaning any of these components. Avoid touching the tweeter domes as any change of their shape may have an impact on sound quality. Clean the cabinet and other plain parts with a soft dry or slightly damp cloth only. Remove dust on the woofer diaphragms with a fine furniture brush. All materials used by Aperion are integrated with exceptional care. By taking care of your speakers you will preserve the finish and build quality for a very long time.

Power handling

Due to the construction and the driver technology Aperion speakers can be driven with very high power levels. With a high quality amplifier, delivering undistorted signals, the speakers can achieve high levels without any compromises in sound quality. Attention must be given to amplifiers with very low power and adjustable tone controls or switches. These types may soon overreach their own performance limits and may send distorted output signals to the speakers, compromising even high quality technology. Any damage caused under such circumstances is not covered by the Aperion Audio warranty.

Room Tuning

The tower & bookshelf speakers are equipped with a "Tweeter Adjustment" feature to fine tune the tweeter's performance for your room.

Tweeter Adjustment

On the backside of the speaker (above the speaker terminals), there is a jumper which will alter the tweeter sound characteristics. Choose between either the 0 dB (neutral sound, with jumper) or the -3dB (dampened higher frequencies, without jumper), based upon your own preference to treble level and the positioning of speakers related to your listening space.

**WARNING! DO NOT CONNECT
THE TWEETER ADJUSTMENT
TO THE AMPLIFIER**

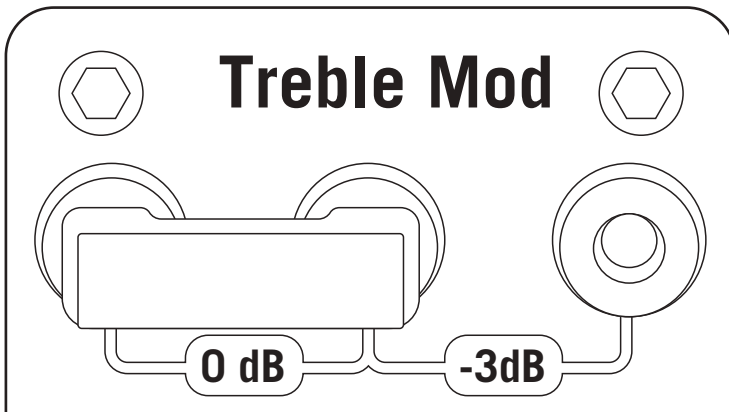

Features, Specifications

Verus III Grand Tower (V6T) Features

- Patented 1.1-inch Aperion Axially Stabilized Radiator™ Silk Dome Tweeter
- Two 5.25" Woven-Kevlar Midrange Drivers with Aluminum Phase Plugs
- Two 6.5" Woven-Kevlar Woofers with PP dust cap and rubber Surrounds
- Furniture-grade Finish
- 5-Way Gold-plated Binding Posts
- Anti-Resonant Cabinet
- Magnetically Attached Grille with Acoustically Transparent Cloth
- Optimized Crossover Network Featuring Mylar & Polypropylene Capacitors
- Bi-ampable
- TrebleMod for Treble Attenuation

On the side of the box labeled "open this end first," you will find the accessory box containing screws, feet, Allen key, carpet spikes and foot pads for the Verus III Grand Tower. Full instructions for attaching the feet are in the included unboxing guide. If you will be placing the Verus III Grand Tower on carpet, use the included carpet spikes. these serve to acoustically decouple the speaker from the floor allowing for the best possible performance. If you have hardwood or tile floors, use the threaded foot pads. While the carpet spikes or foot pads are recommended, they are optional and not required for excellent sound

Package contents

- One (1) Aperion Verus III Grand Tower Speaker
- Two (2) Aluminum Foot Plates
- Four (4) Foot Screws
- One (1) Allen Key for Foot Screws
- Four (4) Metal Carpet spikes
- Four (4) Foot Pads
- One (1) Polish Cloth
- Two (2) Foam Port Plugs

Note: *In most situations the foam port plugs should be removed. If the speakers are placed close to a wall or they sound "boomy" in your room, one or both of the plugs may used to control the bass response.*

Specifications

Frequency Response:	(+/-3dB) 30-35000 Hz
Nominal Impedance:	4 Ohms
Sensitivity:	89 dB
Recommended Power:	20-200 Watts
Driver Configuration:	3-Way
Enclosure Type:	Dual Rear Ported
Product Dimensions(HWD):	43.5" x 8" x 12" / 1105mm x 203mm x 305mm
Product Weight:	59 Lbs / 27 Kg

Features, Specifications

Verus III Grand Bookshelf (V5B) Features

- Patented 1.1-inch Aperion Axially Stabilized Radiator™ Silk Dome Tweeter
- One 5.25" Woven -Kevlar Woofer with Aluminum Phase Plug
- Furniture-grade Finish
- 5-Way Gold-plated Binding Posts
- Anti-Resonant Cabinet
- Magnetically Attached Grille with Acoustically Transparent Cloth
- Optimized Crossover Network Featuring Mylar & polypropylene Capacitors
- TrebleMod for Treble Attenuation

Package Contents

- Two (2) Aperion Verus III Grand Bookshelf Speakers
- Eight (8) Rubber Bumpers
- One (1) Manual
- One (1) Gloves
- One (1) Polish Cloth

Note: *If you are not wall or ceiling mounting the Verus III Grand Bookshelf speakers, be sure to use the included rubber bumpers on the bottom of the speaker to avoid damaging the finish.*

Specifications

Frequency Response:	(+/-3dB) 40-35000 Hz
Nominal Impedance:	6 Ohms
Sensitivity:	85 dB
Recommended Power:	20-100 Watts
Driver Configuration:	2 - Way
Enclosure Type:	Rear Ported
Product Dimensions(HWD):	13" x 7.5" x 9" / 330mm x 190mm x 229mm
Product Weight:	13 Lbs / 6 Kg each

TrebleMod Feature

The Verus III speakers include the TrebleMod feature that allows for reduction of the speaker's high frequency response. On the back of the speaker near the binding posts you will see a set of jumpers labeled TrebleMod and two available configurations, one indicating 0dB and other -3dB. When you unpack your speakers, the jumpers should be in the 0dB position, which is the default setting for the speaker. Should you want to decrease the speaker's high frequency response, simply remove the jumpers from the 0dB position and move them to the configuration labeled -3dB. Remember to keep the setting the same for both speakers. This feature is designed to help the Verus III speakers perform optimally within a variety of different listening environments as well as to accommodate listener preferences. We encourage you to try the speaker with the TrebleMod setting in both the 0dB and -3db positions and to use the configuration that you find to be the most enjoyable for your usage and room.

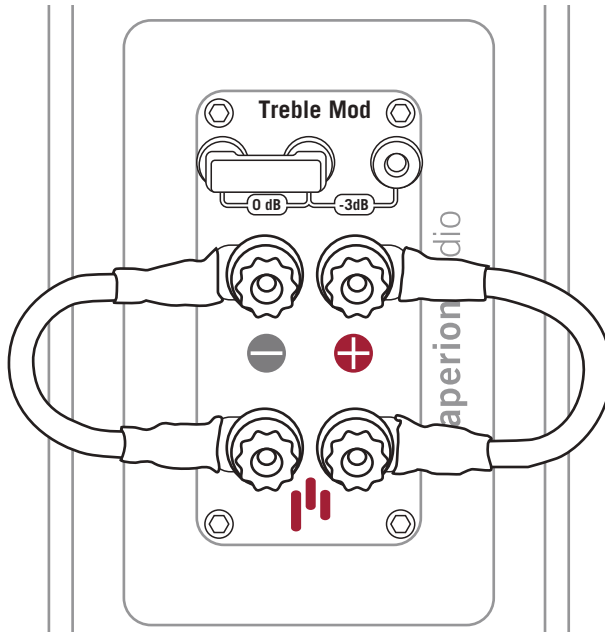

Verus III Grand Center (V6C) Features

- Patented 1.1-inch Aperion Axially Stabilized Radiator™ Silk Dome Tweeter
- One 4" Woven-Kevlar Midrange with Aluminum Phase Plug
- Two 6. 5" Woven-Kevlar Woofers with PVC Dust Cap and Rubber Surrounds
- Furniture-grade Finish
- 5-Way Gold-plated Binding Posts
- Anti-Resonant Cabinet
- Magnetically Attached Grille with Acoustically Transparent Cloth
- Optimized Crossover Network Featuring Mylar & Polypropylene Capacitors
- Treble Mod high frequency adjustment
- 3-way Acoustic Suspension

Package Contents

- One (1) Aperion Verus III Grand Center Speaker
- Two (2) Rubber Wedge Feet , One (1) Manual , One (1) Gloves , One (1) Polish Cloth

Specifications

Frequency Response:	(+/-3dB) 40-35000 Hz
Nominal Impedance:	4 Ohms
Sensitivity:	87 dB
Recommended Power:	20 - 150 Watts
Driver Configuration:	3 - Way
Enclosure Type:	Sealed
Product Dimensions(HWD):	9.25"(w/ rubber feet) x 24.75" x 11" / 235mm x 629mm x 279mm
Product Weight:	33 Lbs / 15 Kg

Treble Mod

The Verus III Grand Center own a high frequency adjustment to compensate the high frequency when the speaker is placed behind a projection screen. These subtle yet effective customizations allow V6C to perform at it's optimal level in various configurations.

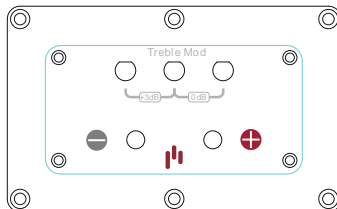

Verus III Concert Tower (V8T) Features

- Patented 1.1-inch Aperion Axially Stabilized Radiator™ Silk Dome Tweeter
- Two 5.25" Woven-Kevlar Midrange Drivers with Aluminum Phase Plugs
- Two 8" Woven-Kevlar Woofers with PP dust cap and rubber Surrounds
- Furniture-grade Finish
- 5-Way Gold-plated Binding Posts
- Anti-Resonant Cabinet
- Magnetically Attached Grille with Acoustically Transparent Cloth
- Optimized Crossover Network Featuring Mylar & Polypropylene Capacitors
- Bi-ampable
- Level Adjustment in the Treble range and Mid range

On the side of the box labeled "open this end first," you will find the accessory box containing screws, feet, Allen key, carpet spikes and foot pads for the Verus III Concert Tower. Full instructions for attaching the feet are in the included unboxing guide.

If you will be placing the Verus III Concert Tower on carpet, use the included carpet spikes. these serve to acoustically decouple the speaker from the floor allowing for the best possible performance. If you have hardwood or tile floors, use the threaded foot pads. While the carpet spikes or foot pads are recommended, they are optional and not required for excellent sound.

Package Contents

- One (1) Aperion Verus III Concert Tower Speaker
- Two (2) Aluminum Foot Plates
- Four (4) Foot Screws
- One (1) Allen Key for Foot Screws
- Four (4) Metal Carpet spikes
- Four (2) Jumper Connectors
- One (1) Polish Cloth
- One (1) Manual
- One (1) Gloves
- Two (2) Foam Port Plugs

Note: *In most situations the foam port plugs should be removed. If the speakers are placed close to a wall or they sound "boomy" in your room, one or both of the plugs may used to control the bass response.*

Features, Specifications

Specifications

Frequency Response:	(+/-3dB) 26-35000 Hz
Nominal Impedance:	4 Ohms
Sensitivity:	91 dB
Recommended Power:	20 - 250 Watts
Driver Configuration:	3-Way
Enclosure Type:	Dual Rear Ported
Product Dimensions(HWD):	51" x 11" x 14" / 1287mm x 269mm x 350mm
Product Weight:	77 Lbs / 35 Kg

Level Adjustment in the Treble range and Mid range (Verus III Concert Tower Only)

For the midrange and tweeter we have chosen a crossover that has a fast transient response and a minimum of phase shifting. The connectors are of a bi-wiring type so that you can connect to the amplifier with double cables (bi-wiring), or connect to one or two amplifiers to further improve the sound.

In the treble range the level is adjustable in four different modes using the supplied loop connector.

Level adjustment in the treble range:

Mode 1/ 0dB

In this mode the sound is neutral with a flat frequency response.

Mode 2/ +2dB

In this mode the treble level is increase by 2dB.

Mode 3/ -2dB

In this mode the treble level is decreased by 2dB.

Mode 4/ -4dB

In this mode the treble level is decreased by 4dB.

In the mid range the level is adjustable in four different modes using the supplied loop connector.

Level adjustment in the mid range:

Mode 1/ 0dB

In this mode the sound is neutral with a flat frequency response.

Mode 2/ +2dB

In this mode the mid level is increase by 2dB.

Mode 3/ -2dB

In this mode the mid level is decreased by 2dB.

Mode 4/ -4 dB

In this mode the mid level is decreased by 4dB.

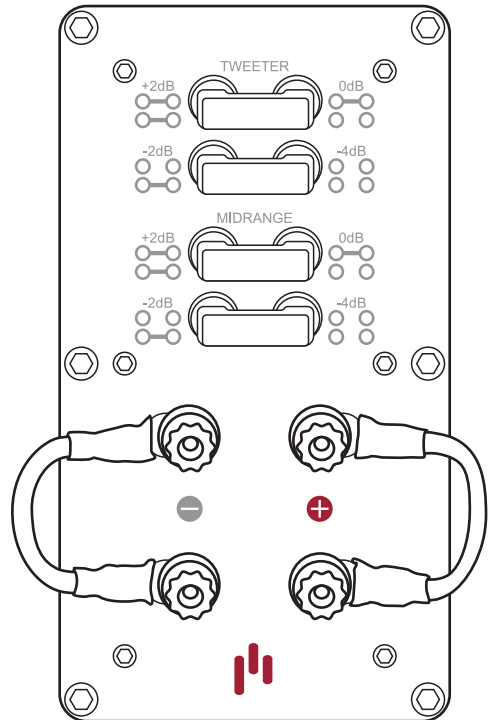

Note: Make sure that all jumpers are connected. A loose jumper may cause a short-circuit if they jam between the terminals.

Verus III Concert Bookshelf (V8B) Features

- Patented 1.1-inch Aperion Axially Stabilized Radiator™ Silk Dome Tweeter
- One 8" Woven -Kevlar Woofer with Aluminum Phase Plug
- Furniture-grade Finish
- 5-Way Gold-plated Binding Posts
- Anti-Resonant Cabinet
- Magnetically Attached Grille with Acoustically Transparent Cloth
- Optimized Crossover Network Featuring Mylar & polypropylene Capacitors
- TrebleMod for Treble Attenuation

Package Contents

- Two (2) Aperion Verus III Concert Bookshelf Speakers
- Eight (8) Rubber Bumpers
- One (1) Manual
- One (1) Gloves
- One (1) Polish Cloth

Note: *If you are not wall or ceiling mounting the Verus III Concert Bookshelf speakers, be sure to use the included rubber bumpers on the bottom of the speaker to avoid damaging the finish.*

Specifications

Frequency Response:	(+/-3dB) 30-35000 Hz
Nominal Impedance:	6 Ohms
Sensitivity:	88 dB
Recommended Power:	20-150 Watts
Driver Configuration:	2 - Way
Enclosure Type:	Rear Ported
Product Dimensions(HWD):	17"x10.6"x13" / 433x269x330 mm
Product Weight:	28 Lbs / 12.7 Kg each

Verus III Concert Center (V8C) Features

- Patented 1.1-inch Aperiion Axially Stabilized Radiator™ Silk Dome Tweeter
- Two 4" Woven-Kevlar Midranges with Aluminum Phase Plug
- Two 8" Woven-Kevlar Woofers with PVC Dust Cap and Rubber Surrounds
- Furniture-grade Finish
- 5-Way Gold-plated Binding Posts
- Anti-Resonant Cabinet
- Magnetically Attached Grille with Acoustically Transparent Cloth
- Optimized Crossover Network Featuring Mylar & Polypropylene Capacitors
- Treble Mod high frequency adjustment
- 3-way Acoustic Suspension

Package Contents

- One (1) Aperiion Verus III Concert Center Speaker
- Two (2) Rubber Wedge Feet , One (1) Manual , One (1) Gloves , One (1) Polish Cloth

Specifications

Frequency Response:	(+/-3dB) 35-35000 Hz
Nominal Impedance:	4 Ohms
Sensitivity:	92 dB
Recommended Power:	20 - 200 Watts
Driver Configuration:	3 - Way
Enclosure Type:	Sealed
Product Dimensions(HWD):	10.6"x31"x13" / 269x784x330 mm
Product Weight:	53.6 Lbs / 24.3 Kg

Treble Mod

The Verus III Concert Center own a high frequency adjustment to compensate the high frequency when the speaker is placed behind a projection screen. These subtle yet effective customizations allow V8C to perform at it's optimal level in various configurations.

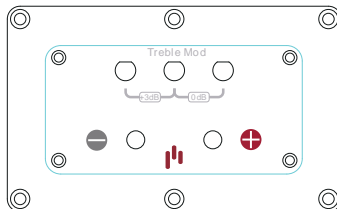

Features, Specifications

Verus III Tripolar Surround Speaker (V8S) Features

- Patented 1.1-inch Aperion Axially Stabilized Radiator™ Silk Dome Tweeter
- Two 4" Aluminum Cone Fullrange Drivers
- One 8" Woven-Kevlar Woofer with PVC Dust Cap and Rubber Surround
- Furniture-grade Finish
- 5-Way Gold-plated Binding Posts
- Anti-Resonant Cabinet
- Magnetically Attached Grille with Acoustically Transparent Cloth
- Optimized Crossover Network Featuring Mylar & polypropylene Capacitors

Package Contents

- Two (2) Aperion Verus III Tripolar Surround Speakers
- Four (4) Rubber Bumpers
- Two (2) AWZ Wall Mounting Brackets
- One (1) Manual
- One (1) Gloves
- One (1) Polish Cloth

Note: *If you are not wall or ceiling mounting the Verus III Tripolar Surround Speakers, be sure to use the included rubber bumpers on the bottom of the speaker to avoid damaging the finish.*

Specifications

Frequency Response:	(+/-3dB) 60-35000 Hz
Nominal Impedance:	6 Ohms
Sensitivity:	92 dB
Recommended Power:	20-150 Watts
Driver Configuration:	3 - Way
Enclosure Type:	Sealed
Product Dimensions(HWD):	14.6"x(12.6"x9.7")x6" / 370x(321x247)x150 mm
Product Weight:	21.5 Lbs / 9.75 Kg each

Contact Us

If you have any questions, comments, or concerns, please don't hesitate to contact any of our Home Theater Gurus at 503.598.8815 or through a live chat via our website at www.aperionaudio.com – we'll be happy to help you out with anything and everything you need.

Aperion Audio

www.aperionaudio.com

customerservice@aperionaudio.com

503-598-8815

Express Limited Warranty

Aperion Audio provides a transferable limited warranty of **Ten (10) years on all cabinets, woofers & midrange drivers, and five (5) years on tweeters for Verus III speakers in USA only!**

These warranties cover all defects in material and workmanship with the following specific exceptions:

- Damage caused by improper installation or adjustment
- Damage caused by accident, unreasonable use, or neglect
- Damage caused by an act of God
- Damage from failure to follow instructions contained in the Owner's Manual
- Damage from repairs performed by someone not authorized by Aperion Audio
- Any unit on which the serial number has been effaced, modified, or removed
- Damage occurring during shipment, other than that arranged by Aperion Audio
- Units which have been altered or modified in design, appearance or construction

This warranty covers only the actual defects within the products themselves. **IT DOES NOT** cover costs of installation in (or removal from) a fixed installation, or normal set-up, claims based on any misrepresentation by the seller, or performance variations resulting from installation related circumstances such as signal quality, AC power or incompatibilities with other system components.

During the warranty period, Aperion Audio will, at its option, either repair the defect, or replace the defective product, or the defective parts, or components thereof with the then current product/component in use by Aperion Audio, at no charge to the owner for parts and labor covered by this warranty. Shipping charges on warranty parts and/or repairs are the responsibility of the customer. If necessary repairs are not covered by this warranty, or if a unit is examined which is not in need of repair, you will be charged for the repairs and/or the examination.

If non-warranted repairs are needed, we will notify you of the estimated cost and ask for your authorization to perform said repairs. The customer must pay shipping charges incurred in getting your product to and from Aperion Audio.

Please save the original shipping cartons, as the unit **MUST** be returned in the original carton and packing.



www.aperionaudio.com

25599 SW 95th Avenue, Suite D, Wilsonville, OR, 97070 - 503.598.8815